



19 Chequerfield Mount, Pontefract, WF8 2BN

Situated on Chequerfield Mount, Pontefract, this charming semi-detached house offers a perfect blend of space and comfort, making it an ideal family home. Spanning an impressive 1,323 square feet, the property boasts four well-proportioned bedrooms, including three spacious double rooms, ensuring ample accommodation for family members or guests.

The heart of the home is the inviting reception room, which provides a warm and welcoming atmosphere for relaxation and social gatherings. The property has been thoughtfully extended to the rear, creating a generous downstairs living area that is perfect for multi-generational living. This versatile space can easily adapt to your family's needs, whether it be a playroom for children, a quiet study, or a comfortable lounge for family gatherings.

With two bathrooms, morning routines will be a breeze, allowing for convenience and privacy for all residents. The layout of the home is designed to maximise both space and functionality, making it a practical choice for modern living.

Chequerfield Mount is a great location, offering a friendly community atmosphere while being conveniently close to local amenities, schools, and transport links. This property presents an excellent opportunity for those seeking a spacious family home in a vibrant area. Don't miss the chance to make this delightful house your new home.

- 4 BEDROOM SEMI-DETACHED HOME
- LARGE OPEN PLAN LIVING/DINING ROOM
- EXTENDED TO THE REAR WITH A BEDROOM AND BATHROOM
- OFF STREET PARKING
- CLOSE TO A OUTSTANDING SCHOOL
- GREAT TRANSPORT LINKS

£190,000

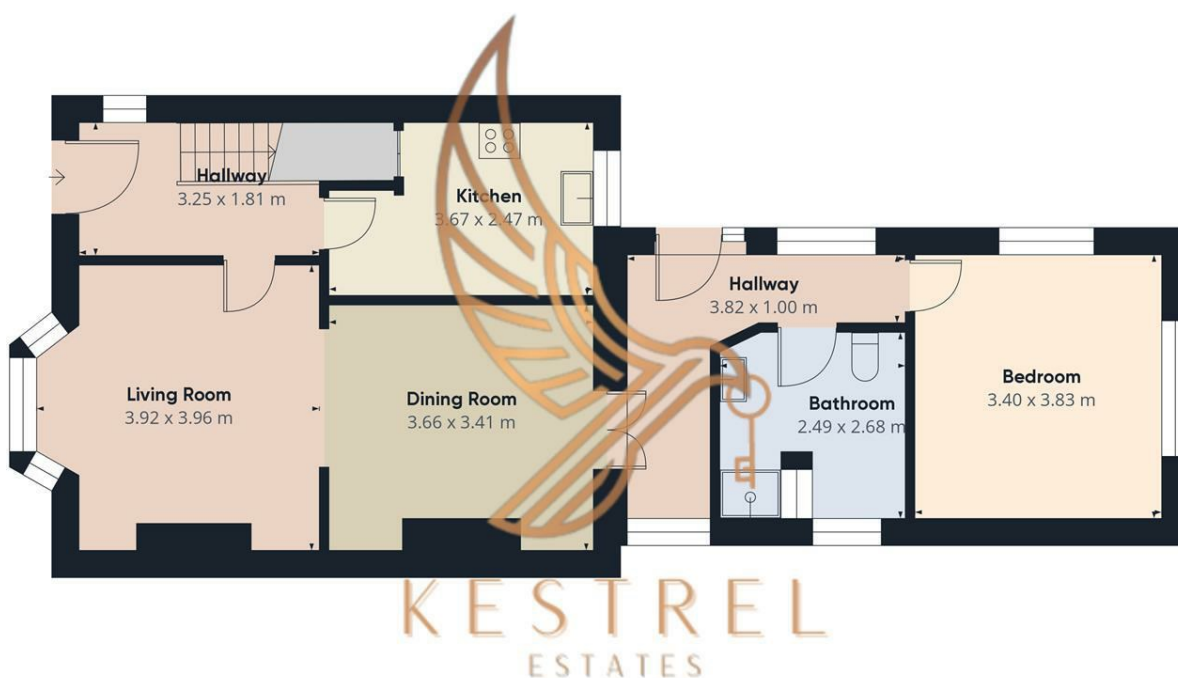

Approximate total area[®]
68.81 m²

(1) Excluding balconies and terraces

While every attempt has been made to ensure accuracy, all measurements are approximate, not to scale. This floor plan is for illustrative purposes only.

Calculations are based on RICS IPMS 3C standard.

GIRAFFE360

